

TECHNICAL DATA

18"CURVED SAFETY ASSIST BAR

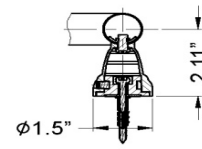
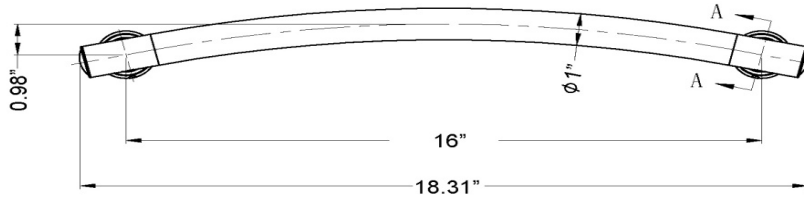
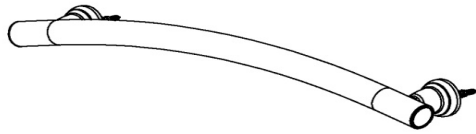

SECTION A-A

Specifications :

- * Safety Bar ~ Material : #304 Stainless Steel Bar
~ Finish : Polished
~ Bar Diameter : 1"
- * Mounting Brackets ~ Material : Zinc alloy
~ Finish : Electro-plated
- * 1-1/2 In. Wall Clearance
- * #10 x 2" Stainless Steel Mounting Screws x 2pcs (Included)
- * ADA Compliant
- * Weight Capacity : 375 lbs

Arista Safety Products



WT International Inc.

555 NORTHLAND DRIVE N.E., BLDG C, ROCKFORD, MI 49341, USA

